



Nustar 5sx

Table of Contents

Statement	1
Chapter 1 Product Intro	2
1.1 Intro.....	2
1.2 Precaution before using battery	2
1.3 Notes.....	3
Chapter 2 Installation Instructions.....	4
2.1 Appearance	4
2.2 Install Micro SD and SIM cards	5
2.3 Battery Charge	5
2.4 Buttons and function area display	6
Chapter 3 Call Function.....	7
3.1 Calling Numbers.....	7
3.2 Contacts	7
3.3 SMS and MMS.....	7
Chapter 4 Barcode Reader	8
Chapter 5 RFID Reader	9
5.1 NFC.....	9
Chapter 6 Other Functions.....	10
6.1 PING tool	10
6.2 Bluetooth	10
6.3 GPS	11
6.4 Volume Setup.....	11
6.5 Sensor.....	12
6.6 Keyboard	12
6.7 OTG Function	13
6.8 Network	13
6.9 Keyboard Emulator	14
Chapter 7 Device Characteristic.....	15

Statement

No part of this publication may be reproduced or used in any form by any electrical or mechanical means without written permission from 3nStar. This includes electronic or mechanical means, such as photocopying, recording, or information storage and retrieval systems. The material in this manual is subject to change without notice.

The software is provided strictly on an “as is” basis. All software, including firmware, furnished to the user is on a licensed basis. 3nStar grants the user a non-transferable and non-exclusive license to use each software or firmware program delivered hereunder (licensed program). As already noted, such license may not be assigned, sublicensed, or otherwise transferred by the user without prior written consent from 3nStar. No right to copy a licensed program in whole or in part is granted, except as permitted under copyright law. The user shall not modify, merge, or incorporate any form or portion of a licensed program with other program material, create a derivative work from a licensed program, or use a licensed program in a network without written permission from 3nStar.

3nStar reserves the right to make changes to any software or product to improve reliability, function, or design.

3nStar does not assume any product liability arising out of, or in connection with, the application or use of any product, circuit, or application described herein.

No license is granted, either expressly or by implication, estoppel, or otherwise under any 3nStar intellectual property rights. An implied license only exists for equipment, circuits, and subsystems contained in 3nStar products.

Chapter 1 Product Intro

1.1 Intro

3nStar Nustar 5sx is a newly developed rugged handheld computer with large screen and strong extensibility. Running on Android™ 11 OS, it is equipped with a Qualcomm Octa-core processor for high-speed processing. With 5.5-inch high-definition display, it is integrated with barcode scanning, NFC, and other functions. The data collection device supports quick charge and UHF sled for good extensibility that can meet the needs in logistics, warehouse, manufacturing, retail, asset tracking, power patrol inspection, etc.

1.2 Precaution before using battery

1. Do not leave the battery unused for long time, no matter if it is in the device or inventory. If the battery has been used for 6 months, it should be checked for its charging function or it should be disposed correctly.
2. The lifespan of Li-ion battery is around 2 to 3 years and can be circularly charged from 300 up to 500 times (one full battery charging period means it's completely charged and completely discharged).
3. When the Li-ion battery is not in use, it will continue discharge slowly. Therefore, battery charging status should be checked frequently and reference of the related battery charging information on the manuals should be taken.
4. Observe and record the information of a newly unused and non-fully charged battery, based on the operating time of the new battery, and compare it with a battery that has been used for a long time. According to product configuration and application program, the operating time of battery would be different.
5. Check the battery charging status at regular intervals.
6. When the battery operating time drops below about 80%, charging time will be increased remarkably.
7. If a battery is stored or otherwise unused for an extended period, be sure to follow the storage instructions in this document. If you do not follow the instructions, and the battery has no charge remaining when you check it, consider it to be damaged. Do not attempt to recharge it or to use it, and instead replace it with a new battery.
8. Store the battery at temperatures between 5 °C and 20 °C (41 °F and 68 °F).

1.3 Notes

1. Using the incorrect battery type causes risk of explosion. Please dispose the used battery according to instructions.
2. Due to the used enclosure material, the product should only be connected to a USB Interface of version 2.0 or higher. Connection to the power USB is prohibited.
3. The adapter should be installed near the equipment and must be easily accessible.
4. The suitable temperature for the product and the accessories is -20°C to 50°C.

CAUTION: RISK OF EXPLOSION IF BATTERY IS REPLACED BY AN INCORRECT BATTERY TYPE. DISPOSE OF USED BATTERIES ACCORDING TO THE INSTRUCTIONS.

Chapter 2 Installation Instructions

2.1 Appearance

Nustar 5sx back and front appearances are showing as follows:



	Button	Description
Side button	1. Power	Locate on right side, press to ON/OFF device.
	2. PTT key	Locate on right side, its function can be defined by software.
	3. SCAN	Scanning button located on both sides. There are two scanning buttons.
	4. Volume +/-	Volume up and down

2.2 Install Micro SD and SIM cards

The card sockets go as follow:

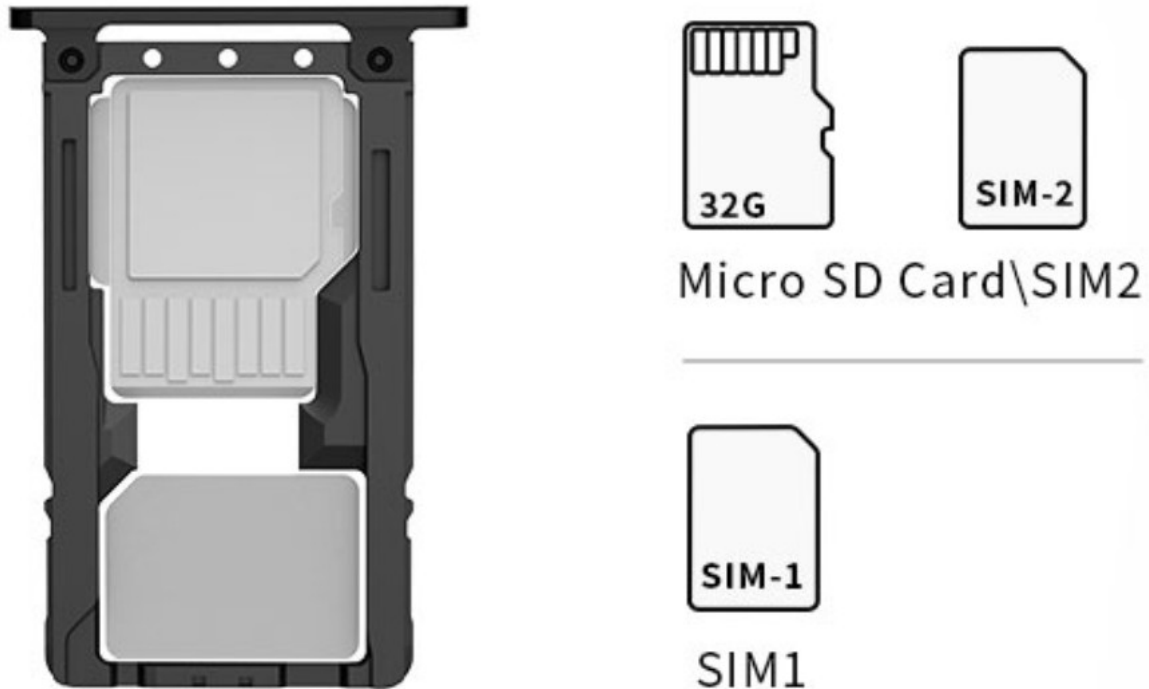

2.3 Battery Charge

By using the USB Type-C contact, the original adaptor should be used for charging the device. Make sure not to use other adaptors to charge the device.

Note:

1. The pistol grip battery will work as a power bank to give power to the main device battery. When the device battery power is under 50%, it starts to charge the main device battery. It will keep charging until the pistol grip battery is at a percentage of 15%.
2. When the pistol grip is installed to the main device, restart the device once so the pistol grip battery will be correctly detected.
3. When put the device with pistol grip together to charge, it will charge the main device battery first, once main device battery is up to 95%, it will start to charge the pistol grip battery.



2.4 Buttons and function area display

Nustar 5sx has 6 side buttons, 2D scanning module locates on the top. HD camera and flashlight locate at rear. NFC identification surrounds the camera.





Chapter 3 Call Function





3.1 Calling Numbers

1. Click the  icon.
2. Click number key to input phone numbers.
3. Click the  icon to call.
4. Click the  icon to end call.

3.2 Contacts

1. Click contacts to open contacts list.
2. Click the  icon to add new contacts.
3. Click the  icon to import/export contacts.

3.3 SMS and MMS

1. Click  to open message window.
2. Click  to input message receiver and contents.
3. Click  to send out messages.
4. Click  to add attachment pictures and videos.

Chapter 4 Barcode Reader

1. In App Center, open the 2D barcode scan test.
2. Press the “SCAN” button or click the scan key to start scanning. The parameter “Auto interval” can be adjusted.

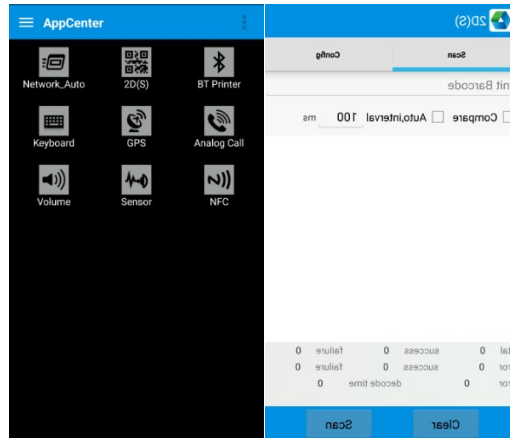

Caution: Please scan codes in the correct way otherwise the scanning will be failed.

2D code:



Max. radiant power: 0.6mW

Wavelength: 655nm

IEC 60825-1 (Ed.2.0).

21CFR 1040.10 and 1040.11 standard.

Chapter 5 RFID Reader

5.1 NFC

Click App Center, open “NFC” to read and write tag information.

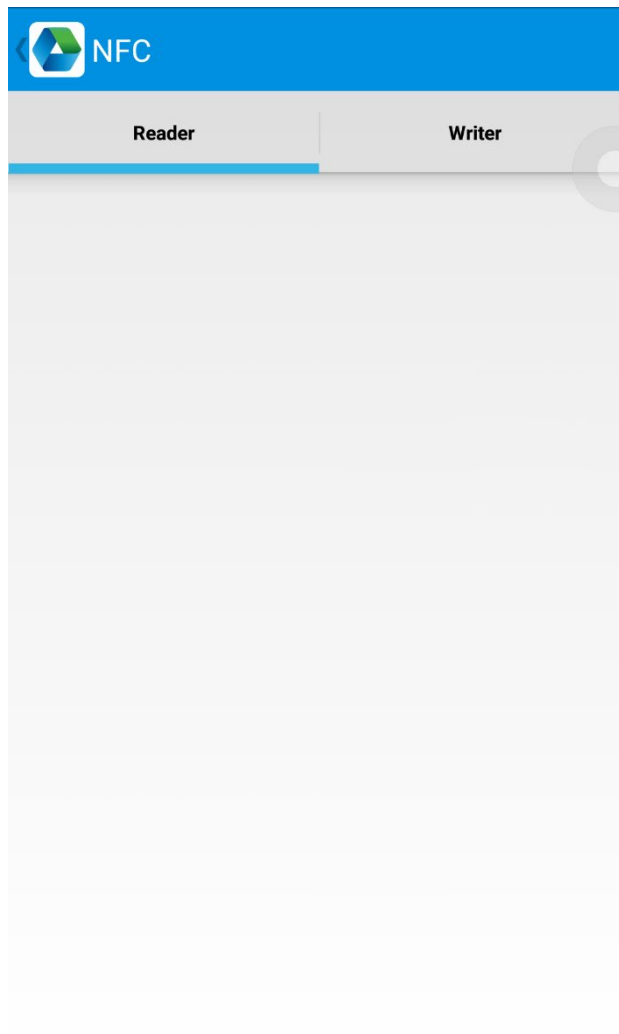

Chapter 6 Other Functions

6.1 PING tool

1. Open “PING” in App Center.
2. Setup PING parameter and select external/internal address.

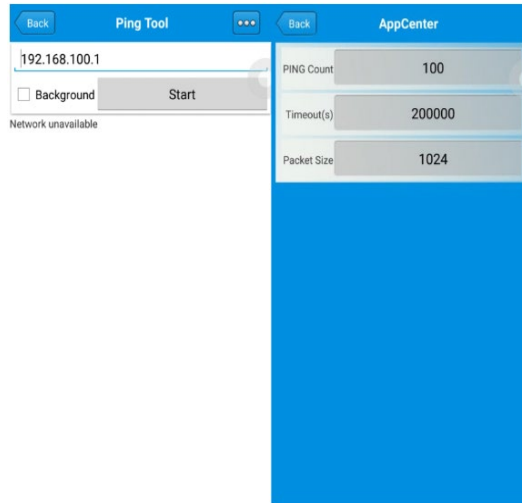

6.2 Bluetooth

1. Open “BT Printer” in App Center.
2. In the list of detected devices, click the device that you want to pair.
3. Select printer and click “Print” to start printing contents.

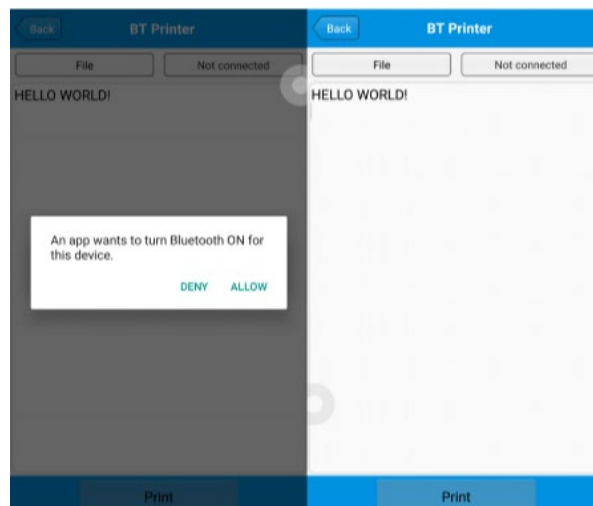

6.3 GPS

1. Click “GPS” in App Center to open the GPS test.
2. Setup GPS parameters to access GPS information.

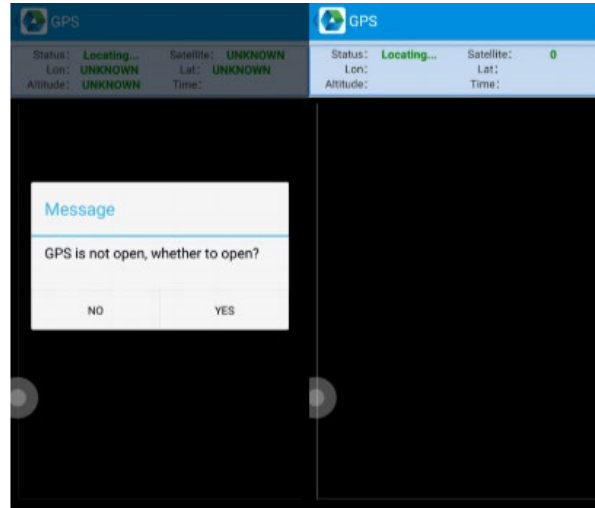

6.4 Volume Setup

1. Click “Volume” in App Center.
2. Setup volume by requirements.

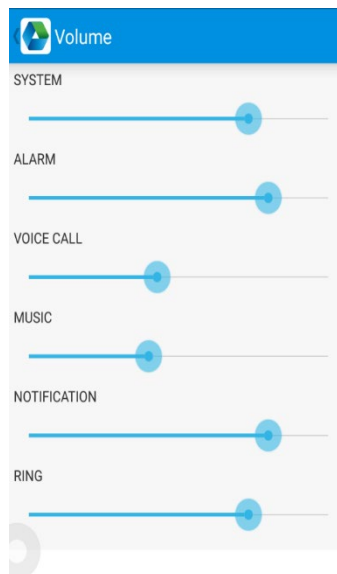

6.5 Sensor

1. Click "Sensor" in App Center.
2. Setup the sensor by requirements.

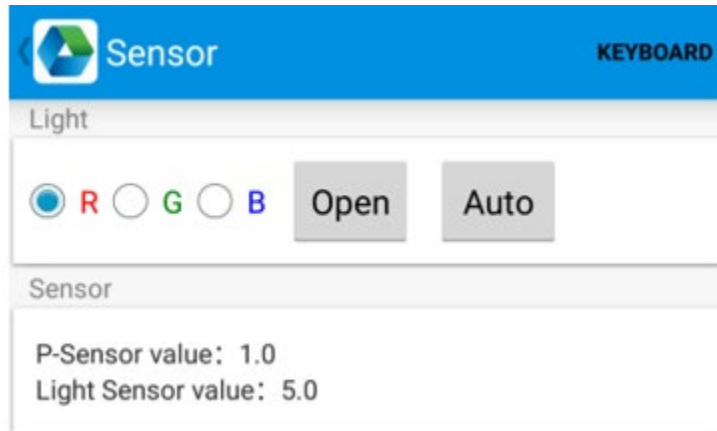

6.6 Keyboard

1. Click "Keyboard" in App Center.
2. Setup and test the main value of the device.

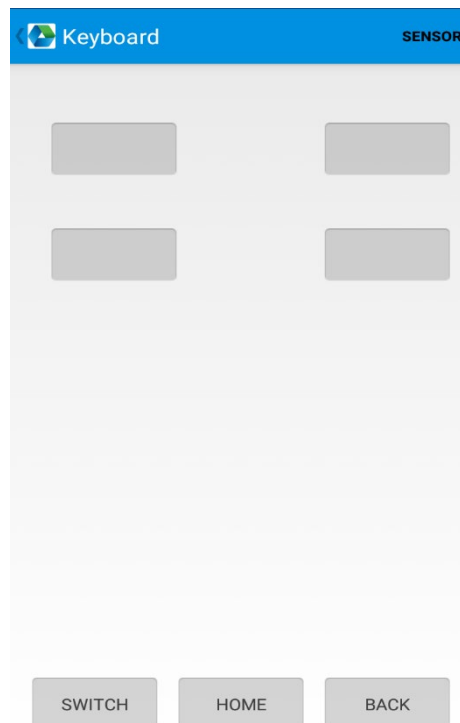

6.7 OTG Function

Nustar 5sx Cradle OTG Connection:

1. Install Nustar 5sx rubber boot.
2. Pay attention to the installing direction of DC0509-BS2 Type C & Pogo Pin.
3. Install the device onto cradle and select OTG mode on the pop-up menu to switch on OTG.

6.8 Network

1. Click “Network” in App Center.
2. Test WIFI/Mobile signal by requirements.

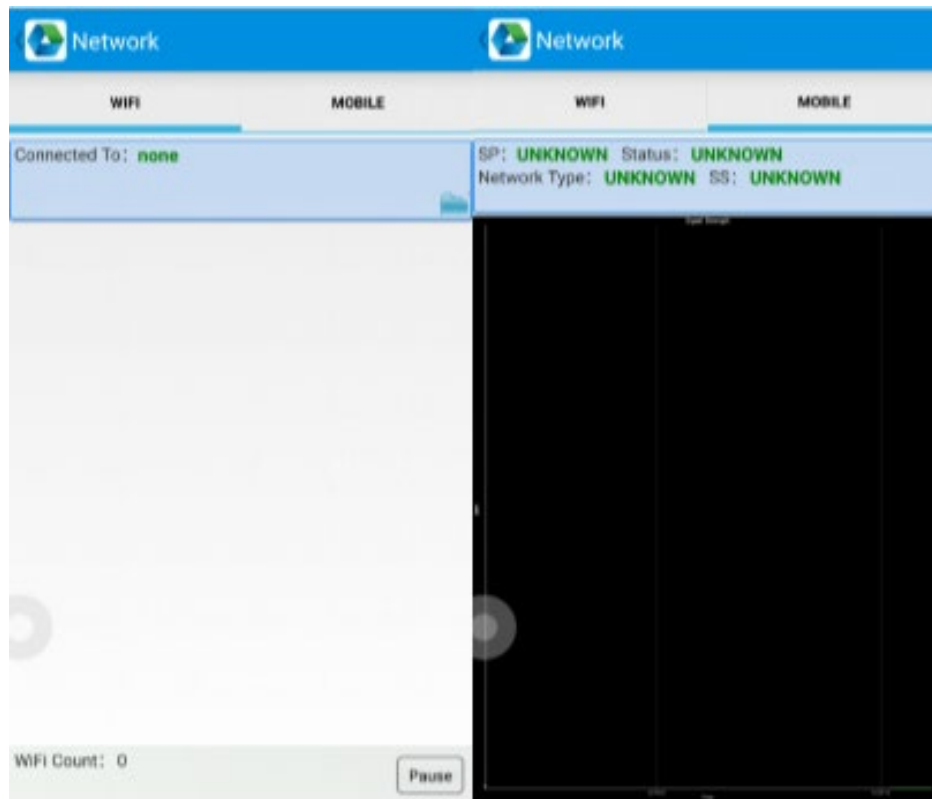

6.9 Keyboard Emulator

The keyboard emulator can be used in multiple operating background and output formats directly. It includes Prefix/Suffix/Enter/TAB.

Please check the keyboard emulator manual for more details.

Note:

For each model, keycode of side button would be different, so user needs to use the keyboard in App Center to check keycode and bind in Barcode2D.

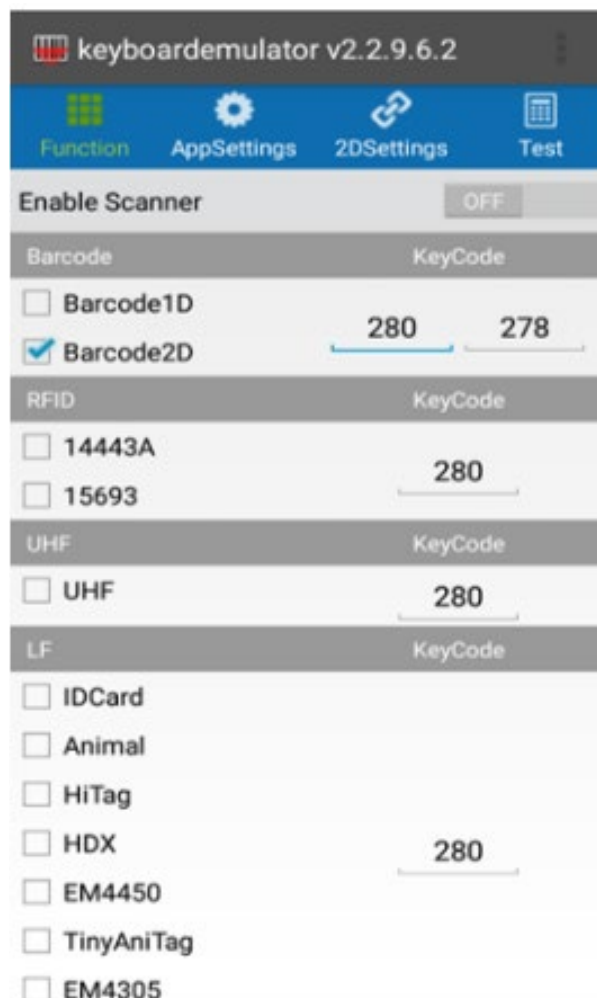

Chapter 7 Device Characteristic

Physical Characteristics

Size	160x76x15.5mm / 6.3*2.99*0.61in
Weight	< 287g/10.12oz(with battery)
Display	5.5-inch display, IPS LTPS 1440*720
Touch Panel	Corning Gorilla Glass, multi-touch panel, gloves and wet hands supported
Battery	4420mAh(type)/4300mAh(min) removable main battery, 5200 mAh optional pistol battery, support QC3.0 and RTC Standby: up to 490 hours (only main battery; Wi-Fi: up to 470h; 4G: up to 440h) Continuous use: over 12 hours (depending on user environment) Charging time: 2.5hours (charge device by standard adaptor and USB cable)
Expansion	Supports up to 128 GB Micro SD card
Expansion Slot	2 slots for SIM card, 1 slot for TF card
Audio	2 Microphones, 1 for noise reduction
Camera	13MP autofocus camera with flashlight

Performance

CPU	Qualcomm 2.0 GHz Octa-core
OS	Android 11
RAM	3GB
Communication Interface	USB3.1, Type-C, OTG
ROM	32GB
Max. expansion	Supports up to 128 GB Micro SD card

User Environment

Operating temp.	-20°C to 50°C
Storage Temp.	-40°C to 70°C
Humidity	5%RH - 95%RH noncondensing
Sealing	IP65, IEC sealing standard
Drop specification	Multiple 1.8m/5.91ft drops (at least 20 times) to the concrete across the operating temperature range Multiple 2.4m/7.87ft drops (at least 20 times) to the concrete after installed rubber bumper

Communication

WAN	EU/CH: 2G: 900/1800MHz 3G: CDMA EVDO: BC0 WCDMA: 900/2100MHz TD-SCDMA: A/F(B34/B39) 4G: B1, B3, B5, B7, B8, B20, B28A, B28B, B38, B39, B40, B41 US: 2G: 850/1900MHz 3G: 850/1900MHz, B4 CDMA: BC0 4G: B2/B4/B5/B7/B12/B13/B17/B38
Vo-LTE	Support Vo-LTE HD video voice call
WLAN	Support 802.11 a/b/g/n/ac/d/e/h/i/k/r/v, 2.4G/5G dual-band, IPV4, IPV6, 5G PA
Bluetooth	Bluetooth 5.1, BR+EDR+LE

Data Collection

Barcode scanning	SE4710
RFID	NFC 13.56Mhz

Developing Environment

SDK	Software development kit
Language	Java
Develop	Eclipse/Android Studio